



## Infinity 17" waterproof tv.

### Key Features:

- ✓ WXGA LCD TFT Panel
- ✓ Built in 'FREEVIEW', Digital Tuner plus Analogue Tuner
- ✓ IP66 – suitable for all wet environments, both indoor and outdoor
- ✓ Can be recessed into a wall or mounted using VESA fixings
- ✓ Connects to separate speakers supplied free
- ✓ Waterproof remote control

### Technical Specification:

- Panel: 17" TFT LCD (16:9)
- Waterproof Rating: IP66
- Operating Temp: 0 - +50 (degrees C)
- Storage Temp: -20 - +60 (degrees C)
- Brightness: 500cd/m2
- Contrast: 700:1
- View Angle: H:170 V:160
- Max. Resolution: 1440 x 900
- Power Input: 10V-40V DC
- Signal Input: TV/AV, 75Ω composite video
- System: DVBT / PAL
- TV Dimensions: w x h x d (mm)
- Net Weight: 3.0Kgs

### Inputs:

- 1 \* DVBT Digital Tuner
- 1 \* PAL Analogue Tuner
- 2 \* Composite
- 2 \* Audio Output

### Box Contents:



First Fix Back Box (if to be recessed), Fully waterproof Unit, Waterproof Remote, Manual.

Please note speakers are included in the packaging.

## Quick Installation Guide:

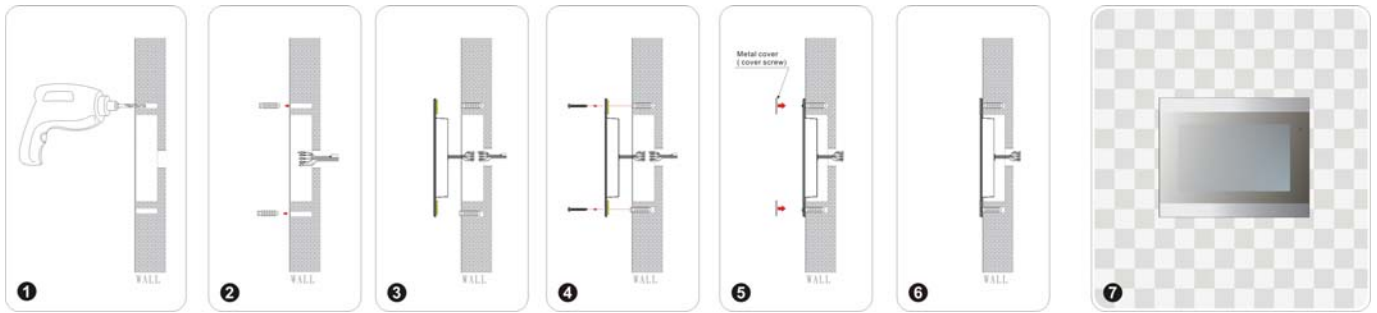

### Step 1:

Cut out space for the back box (supplied) and drill pilot holes for fixing screws.

### Step 2:

Plug the screw holes and feed the required leads to the back box.

### Step 3:

Connect up the leads from the back of the unit.

### Step 4:

Apply a thin bead of sealant to the back of the unit (to prevent condensation getting into the wall tie) and screw the unit into place.

### Step 5:

Fix the decorative screw hole covers (opposite)

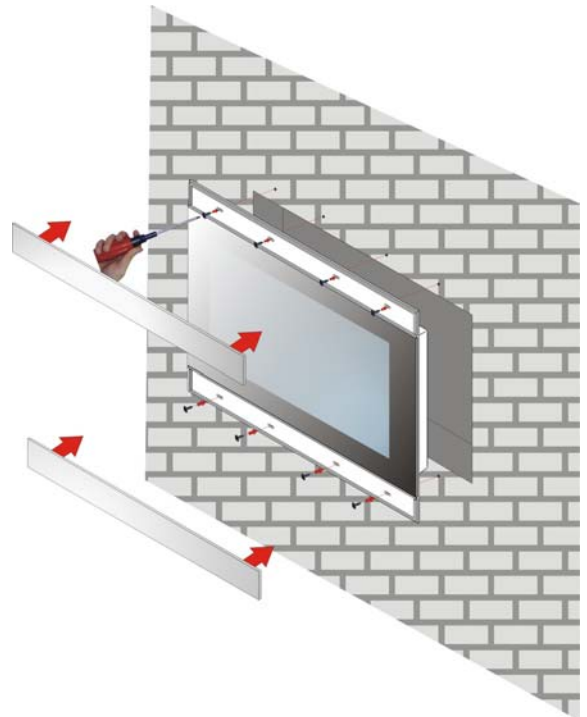

**As this unit is completely waterproof it does not have to be recessed. The unit has VESA fixing holes on the back so that it can be mounted on a bracket giving flexibility of installation.**

- ✓ Glass Panel background comes in Black or Mirror finish.
- ✓ Trim panels are available in black or satin aluminium finish
- ✓ The decorative screw hole covers can be a bespoke solution for a minimum order. (ie wood or chrome)