



# Infiniti range



## Infiniti range

The 'Infiniti range' has been designed to keep time and cost of installation to an absolute minimum. The unit is a fully sealed waterproof unit, with VESA fixing holes on the back, this means the TV can be mounted directly onto any surface without the need to recess. However, if a recessed unit is what you require, then a back box is provided to enable this method of installation.

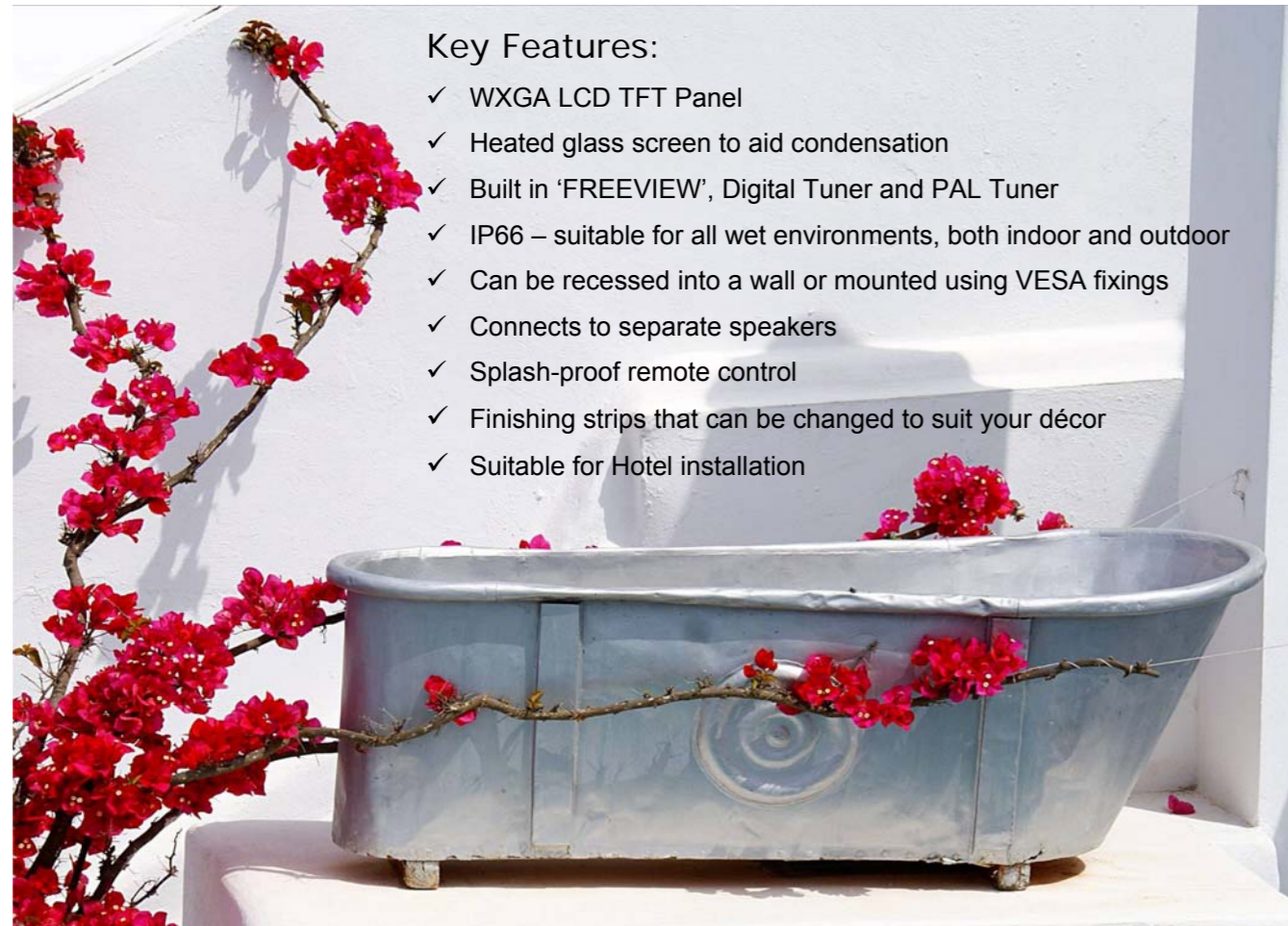

### Key Features:

- ✓ WXGA LCD TFT Panel
- ✓ Heated glass screen to aid condensation
- ✓ Built in 'FREEVIEW', Digital Tuner and PAL Tuner
- ✓ IP66 – suitable for all wet environments, both indoor and outdoor
- ✓ Can be recessed into a wall or mounted using VESA fixings
- ✓ Connects to separate speakers
- ✓ Splash-proof remote control
- ✓ Finishing strips that can be changed to suit your décor
- ✓ Suitable for Hotel installation

### Standard Finishes:

Black or White surround with Stainless Steel finishing strips. Mirror finish also available.



Black surround/Stainless Steel Strips



White surround/Stainless Steel Strips

### Bespoke Finishes:

The stainless steel finishing strips can be covered in a choice of laminate finishes to create your desired look. Alternatively, they can be made from any other material, i.e, wood, chrome, to match your décor. (A minimum order may be required.)

## The Range:



### TW700 – Infiniti 7 inch model

#### Technical Spec:

- Brightness: 350cd/m2
- Contrast: 500:1
- View Angle: H:170 V:160
- Max. Resolution: 1440 x 234
- TV Dimensions: 228w x 185h x 35d (mm)
- Net Weight: 1.5Kgs

#### Inputs:

- 1 \* DVBT Digital Tuner (PAL Optional)
- 1 \* Composite
- 2 \* Audio Output (Left & Right)

### TW1701 – Infiniti 17 inch model

#### Technical Spec:

- Brightness: 500cd/m2
- Contrast: 700:1
- View Angle: H:170 V:160
- Max. Resolution: 1440 x 900
- TV Dimensions: 476w x 397h x 40d (mm)
- Net Weight: 5.0Kgs

#### Inputs:

- 1 \* DVBT Digital Tuner
- 1 \* PAL Analogue Tuner
- 2 \* Composite
- 2 \* Audio Output

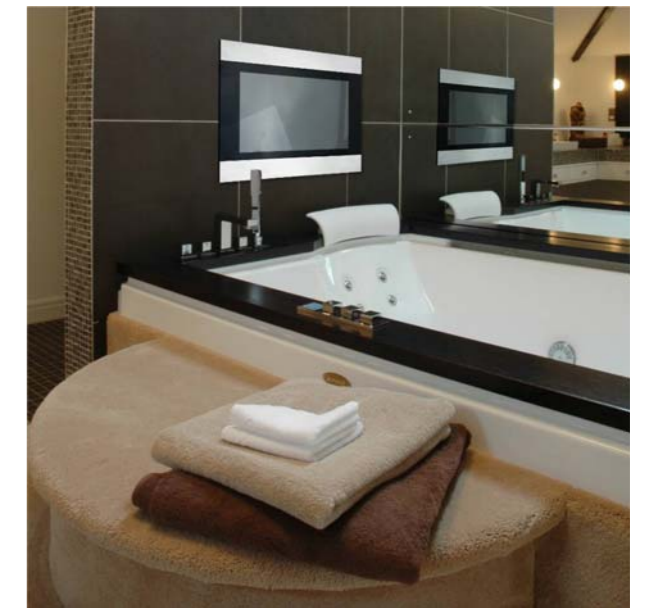

### TW2600 – Infiniti 26 inch model

#### Technical Spec:

- Brightness: 500cd/m2
- Contrast: 1000:1
- View Angle: H:172 V:172
- Max. Resolution: 1366 x 768
- TV Dimensions: 728w x 564h x 85d (mm)
- Net Weight: 8.0Kgs

#### Inputs:

- 1 \* DVBT Digital Tuner
- 1 \* PAL Analogue Tuner
- 2 \* Composite
- 2 \* Audio Output

## Recessed Installation Guide:

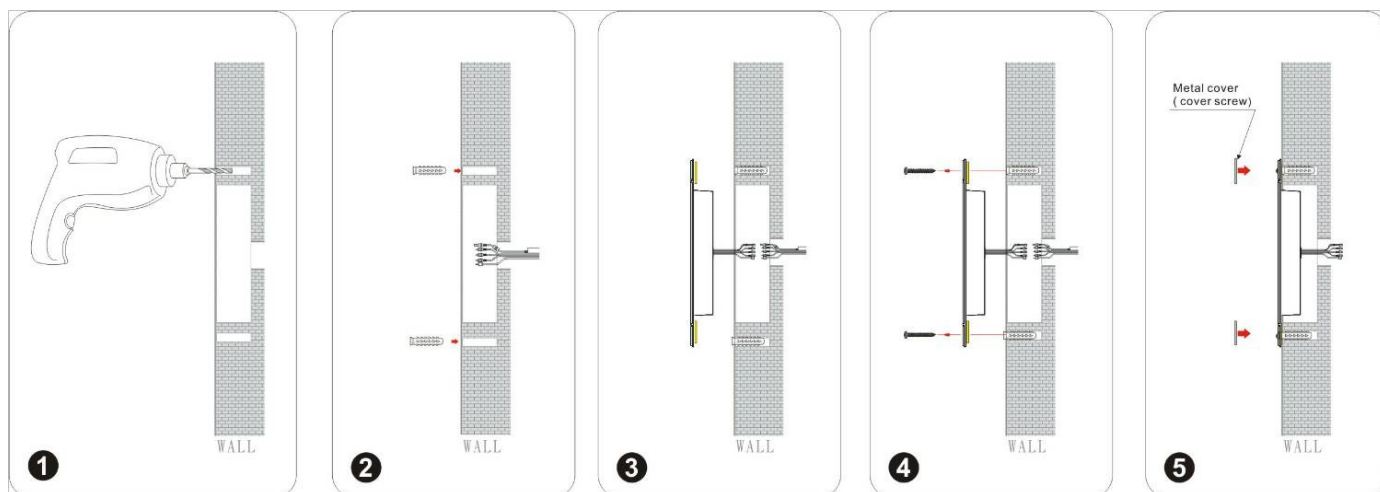

### Step 1:

Cut out space for the back box (supplied if required) and drill pilot holes for fixing screws.

### Step 2:

Plug the screw holes and feed the required leads to the back box.

### Step 3:

Connect up the leads from the back of the unit.

### Step 4:

Apply a thin bead of sealant to the back of the unit (to prevent condensation getting into the wall tie) and screw the unit into place

### Step 5:

Fix the decorative screw hole covers (as shown opposite).

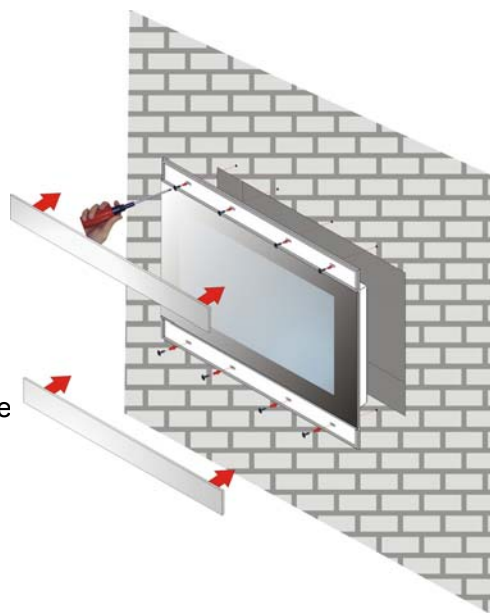

## Back Box Cut Out:

Model No.	Width (mm)	Height (mm)	Depth (mm)
<b>TW700</b>	223.9	140.4	55.6
<b>TW1701</b>	465.5	297.8	43.2
<b>TW2600</b>	696.0	402.0	85.6

## VESA Mount Installation:

Please note that as this unit is a fully sealed waterproof unit and has VESA screw hole fixings on the back, it does not have to be recessed, but can simply be mounted on any standard VESA bracket. (VESA bracket is not supplied.)